

GROUND FLOOR PLAN (1:50)

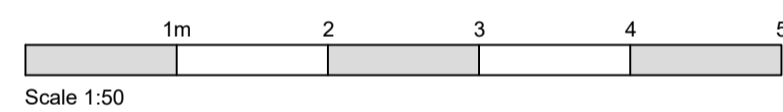

Scale 1:50

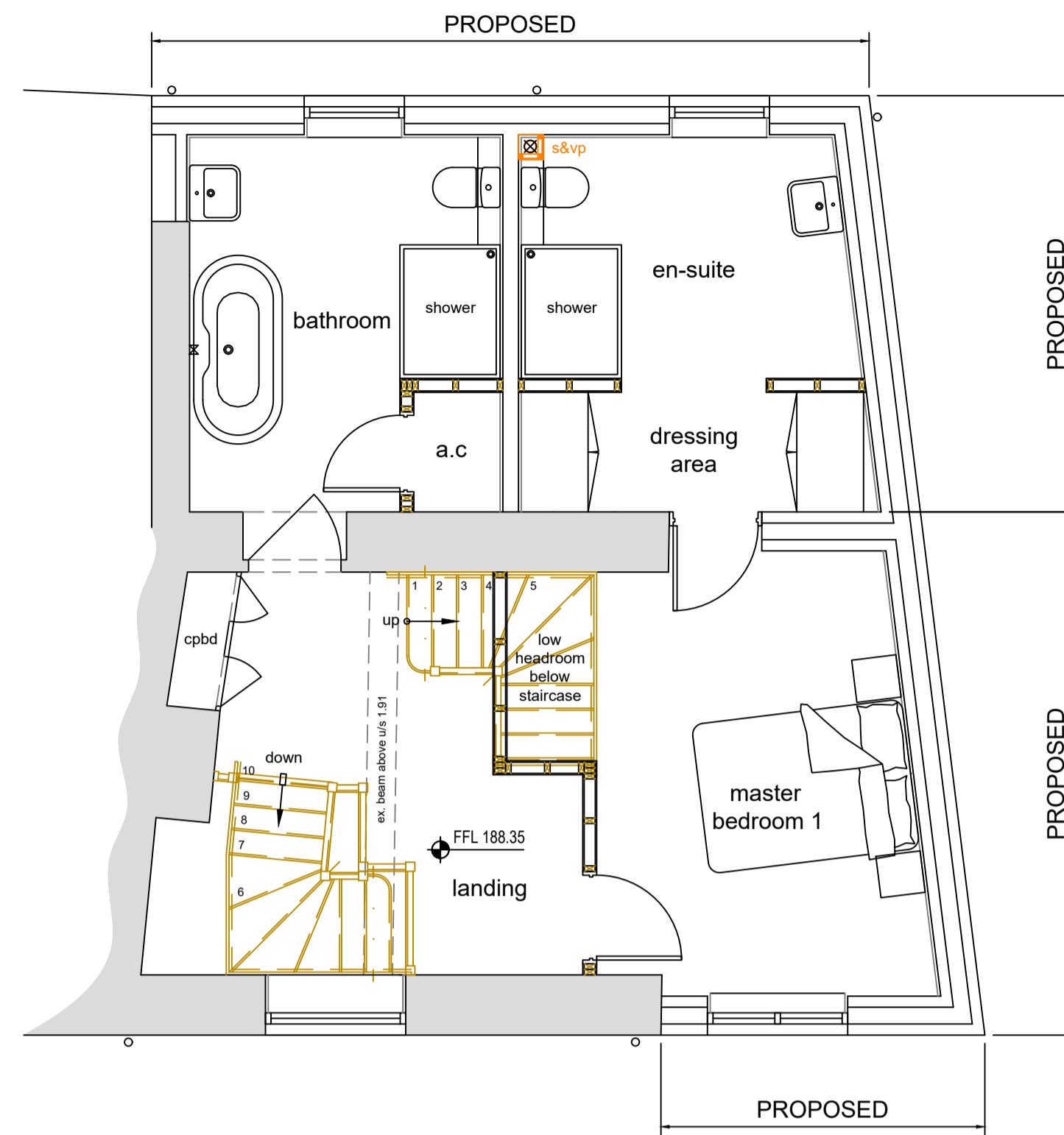
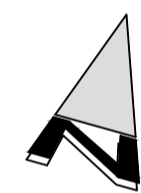

FIRST FLOOR PLAN (1:50)



Scale 1:50

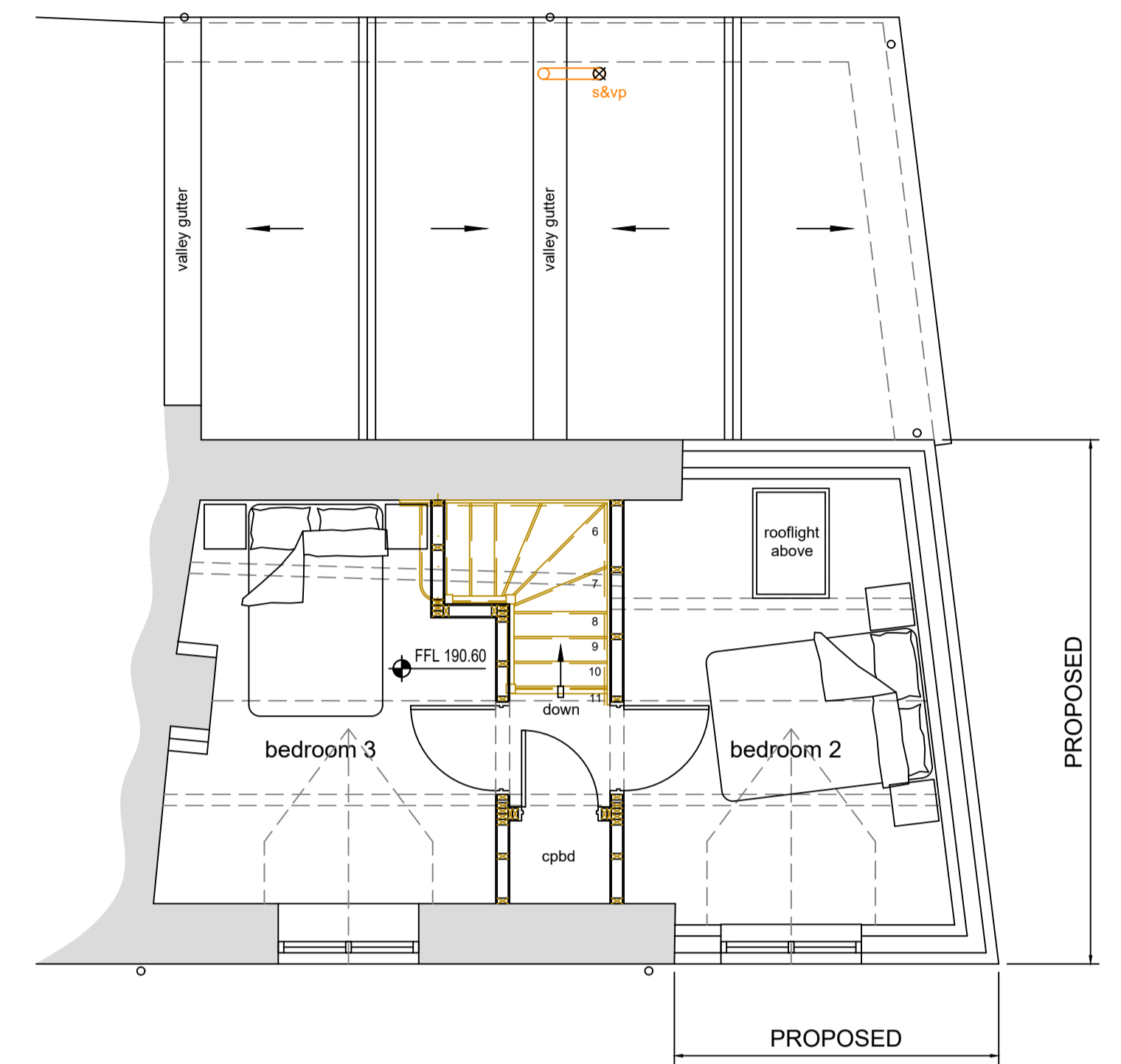

SECOND FLOOR PLAN (1:50)



Scale 1:50

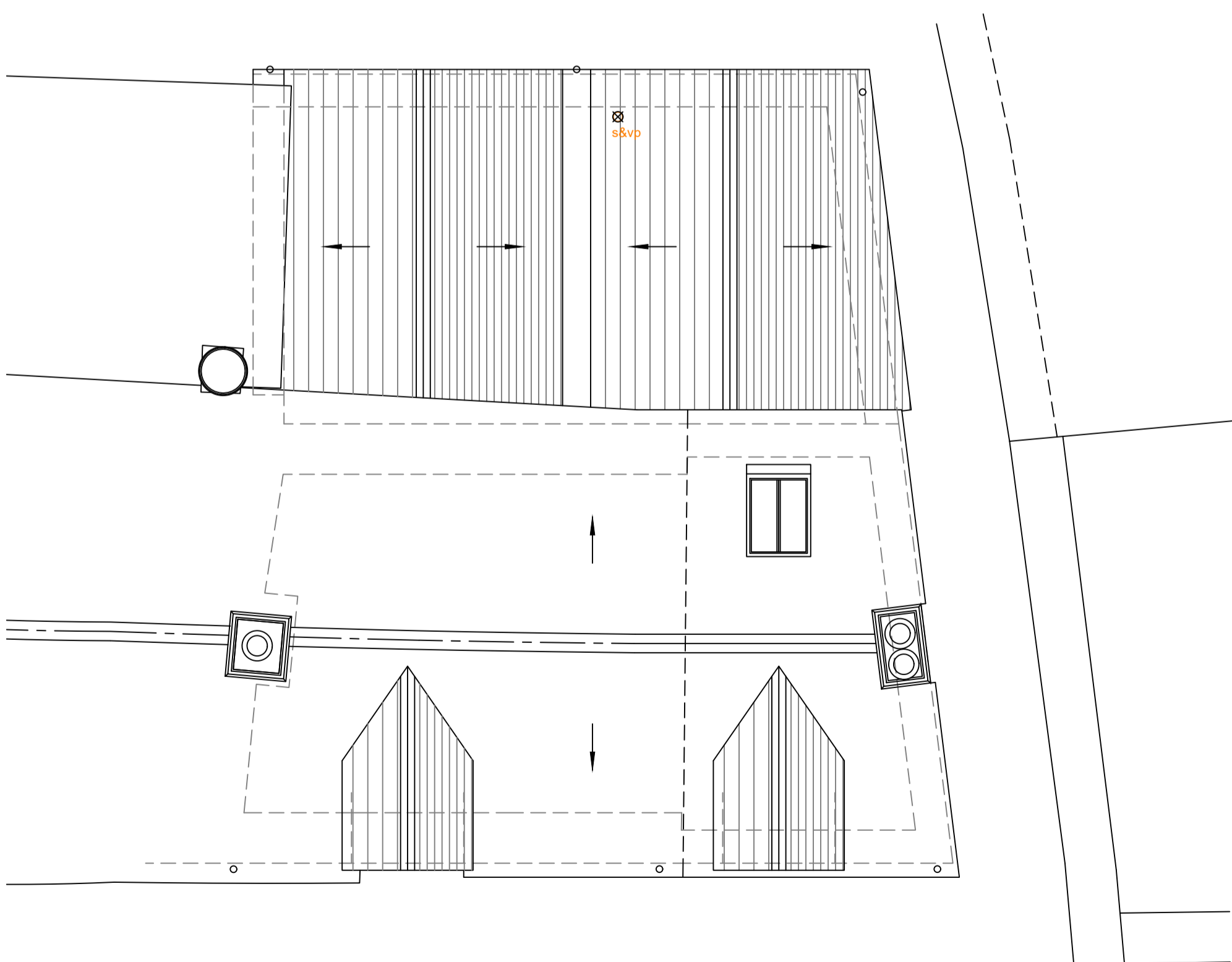

ROOF PLAN (1:50)



Scale 1:50

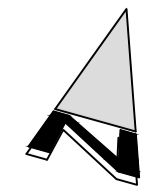

**GENERAL NOTES:**

RESIDENTIAL DWELLING - EXISTING GROSS EXTERNAL AREA GROUND FLOOR (GEA): = 60.8m<sup>2</sup>

**PROPOSED MATERIALS:**

ROOFING: NATURAL BLUE SLATE ROOFING TILES TO MATCH THAT OF THE EXISTING.

WALLS: NATURAL STONE WALLING WITH STONE HEAD DETAIL TO WINDOW AND DOORS.

DOOR & WINDOWS: TIMBER FRONT ENTRANCE DOOR & FRAME, TIMBER FRAMED DOORS & WINDOWS WITH DOUBLE GLAZED UNITS, COLOUR: TO BE CONFIRMED.

GUTTERING & RWP: GUTTERS BRETT MARTIN CAST IRON EFFECT CASCADE 112MM GUTTERING SYSTEM, COMPLETE WITH OUTLETS, STOP ENDS & FIXING BRACKETS. 68MM ROUND RAIN WATER PIPES, COLOUR: TBC.

**Proposed 3 Bedroom Dwelling:**

GIA Ground Floor = 46.7m<sup>2</sup>  
 GIA First Floor = 47.5m<sup>2</sup>  
 GIA Second Floor = 24.9m<sup>2</sup>  
 Total GIA = 119.1m<sup>2</sup>  
 (1282 sq ft)

B	Floor & Roof plans revised following comments from the local authority planning officer & conservation officer.	DMM	07/08/23	
A	Kitchen extended and en-suite added to master bedroom.	DMM		
Revision	Description	Drawn	Date	Checked
		DMM	13/06/23	
				Approved

Revisions  
 0 This drawing may have been reduced original scale: 100mm

This drawing is the copyright of Guiding Light Architecture Ltd in accordance with Section 16 of the Copyright Designs & Patents Act 1988, and cannot be reproduced in part or whole without prior written consent and is not available for third party use.

Project: MRS R. EADY  
 VALLEY VIEW, CHAPEL STREET, MAUGERSBURY, STOW ON THE WOLD, GLOS, GL54 1HR  
 Title: PROPOSED SIDE & REAR EXTENSION. PROPOSED GROUND, FIRST & SECOND FLOOR PLANS AND ROOF PLAN.

Scale	Drawn	Checked	Approved
1:50 @ A1	DMM	-	-
CAD Ref	Date	Date	Date
-	29/04/2023	-	-



GUIDING LIGHT ARCHITECTURE LTD  
 17 Fosseyway Drive, Moreton in Marsh, Gloucestershire, GL56 0DU  
 TEL: 07905 292415 EMAIL: info@guidinglightarchitecture.co.uk  
 www.guidinglightarchitecture.co.uk © Copyright

Project number	Drawing number	Revision
2303-129	2303-129-07	B

PLANNING ISSUE