

Viewport Key

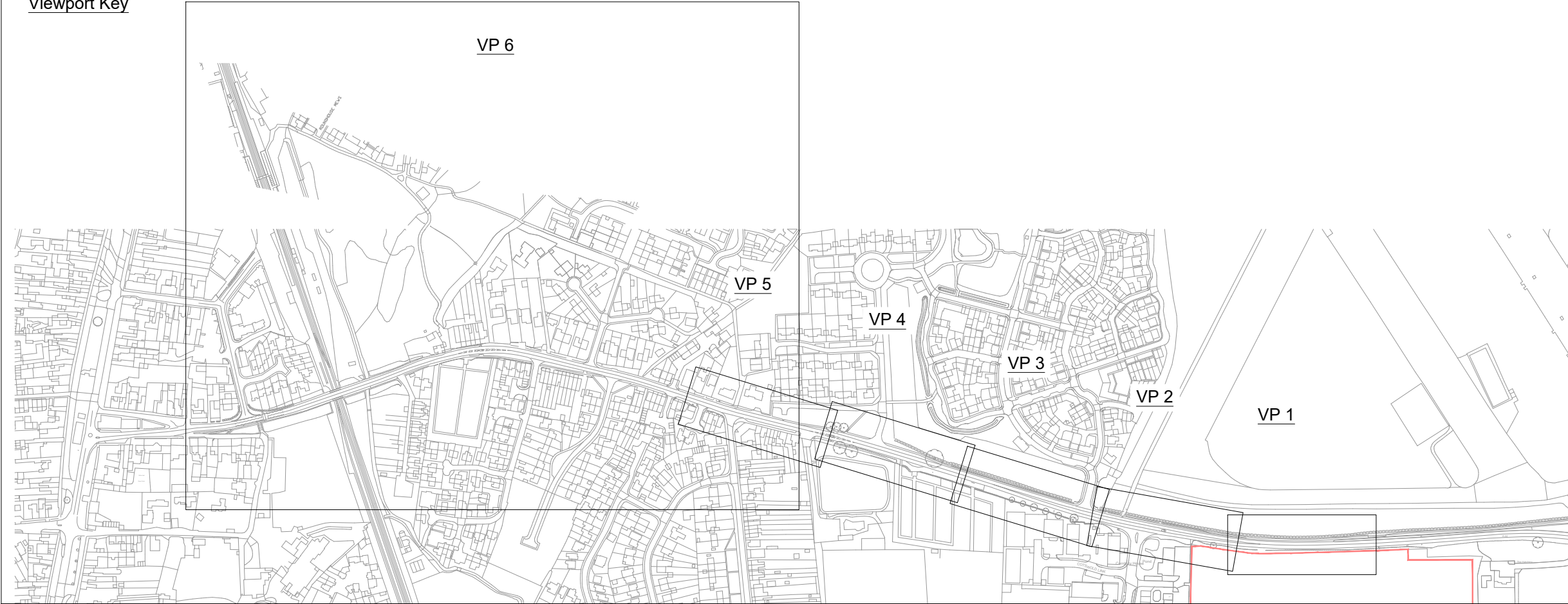

VP 1

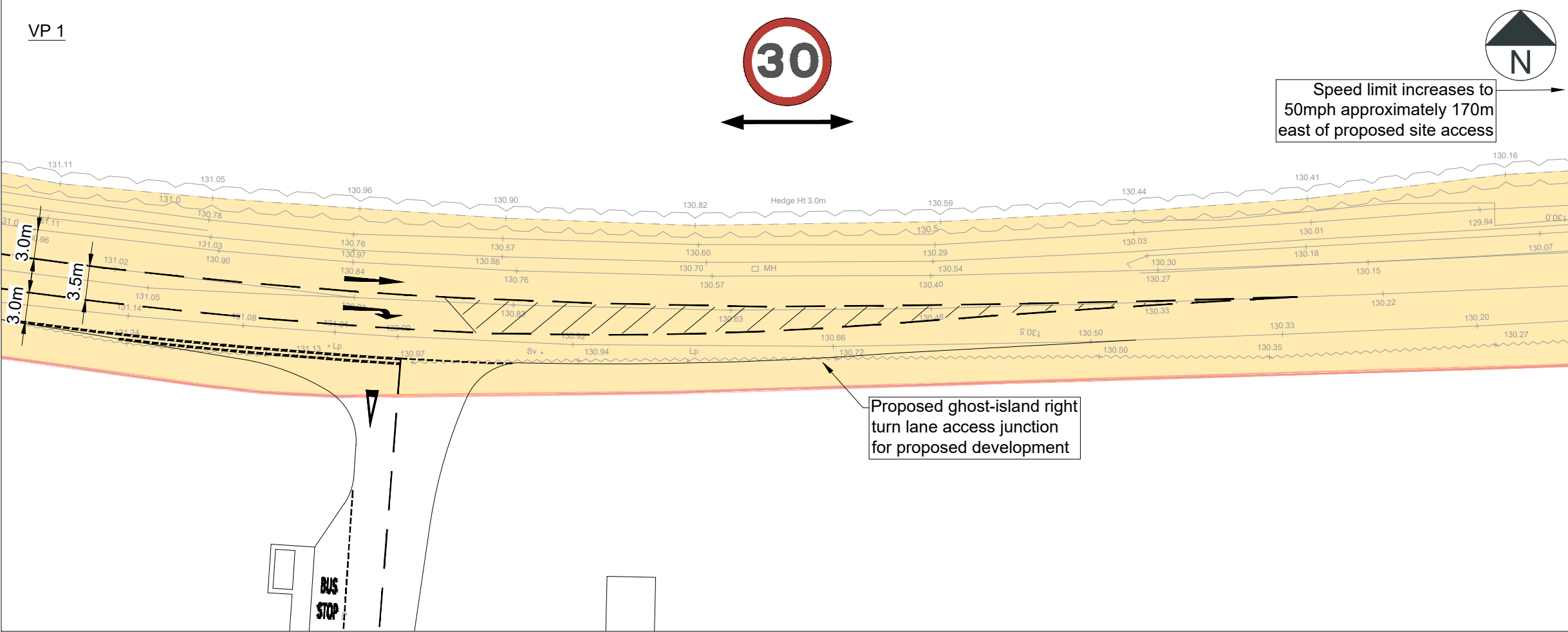

Notes:

1. Do not scale from this drawing. All dimensions are in metres, unless stated otherwise.
2. The topographical survey was undertaken by Axis Surveys, drawing number x-topo london road, dated November 2023.
3. Highway boundary information has been provided by Gloucestershire County Council, 11/08/2021, and has been overlaid by Rappor onto the Topographical Survey & Ordnance Survey on a best fit basis.
4. Ordnance Survey, (c) Crown Copyright 2020. All rights reserved. Licence 100022432.
5. Drawing to be read in conjunction with all other drawings. Any discrepancies are to be reported to the engineer 5 working days in advance of undertaking any work.
6. The layout is subject to detailed design, capacity testing, ground investigations & earth modelling, road safety audit, utilities & services and confirmation of land ownership.
7. Use of the drawing does not absolve the client from their responsibilities in regards to health & safety and CDM regulations.

Key:

- Indicative Site Boundary
- Adopted Highway Boundary

P06	31.07.25	Updated drawing title & viewport key	SB	JM
P05	07.01.25	Updated internal highway layout	PC	JM
P04	12.12.24	Updated access junction	AS	JM
P03	05.12.24	Updated access junction dimensions	AS	JM
P02	02.12.24	Minor amendments	AS	JM
P01	05.11.24	Minor amendments	AS	JM

Rev	Date	Details	By	Chkd
-----	------	---------	----	------

rappor



CLIENT: Bloor Homes

PROJECT: Land South of London Road, Moreton-in-Marsh

TITLE: London Road Active Travel Route (Sheet 1 of 4)

SCALE @ A3: 1:500	DATE: 28.10.24	DRAWN: AS	CHECKED: JM	APPROVED: JM
----------------------	-------------------	--------------	----------------	-----------------

STATUS: INFORMATION

DRAWING NO: 210431-RAP-XX-XX-DR-TP-6011	REVISION: P06
--	------------------