

NOTES:  
 1. Scaled dimensions can be taken from this drawing if printed at the correct size and scale.  
 2. Responsibility is not accepted for errors made by others in scaling from this drawing.  
 3. This drawing must be read in conjunction with all relevant drawings, documents and information prepared by the Architects, other Consultants and Specialists.  
 4. Any discrepancy on this drawing must be referred to the Architects and clarification obtained before any action by others and prior to commencement of works.  
 5. All dimensions must be checked on site before any action by others and prior to commencement of work or the preparation of Specialists drawings.  
 6. The copyright of this drawing remains with the Architect.  
 7. If in doubt ask!

REVISIONS

--	--	--	--

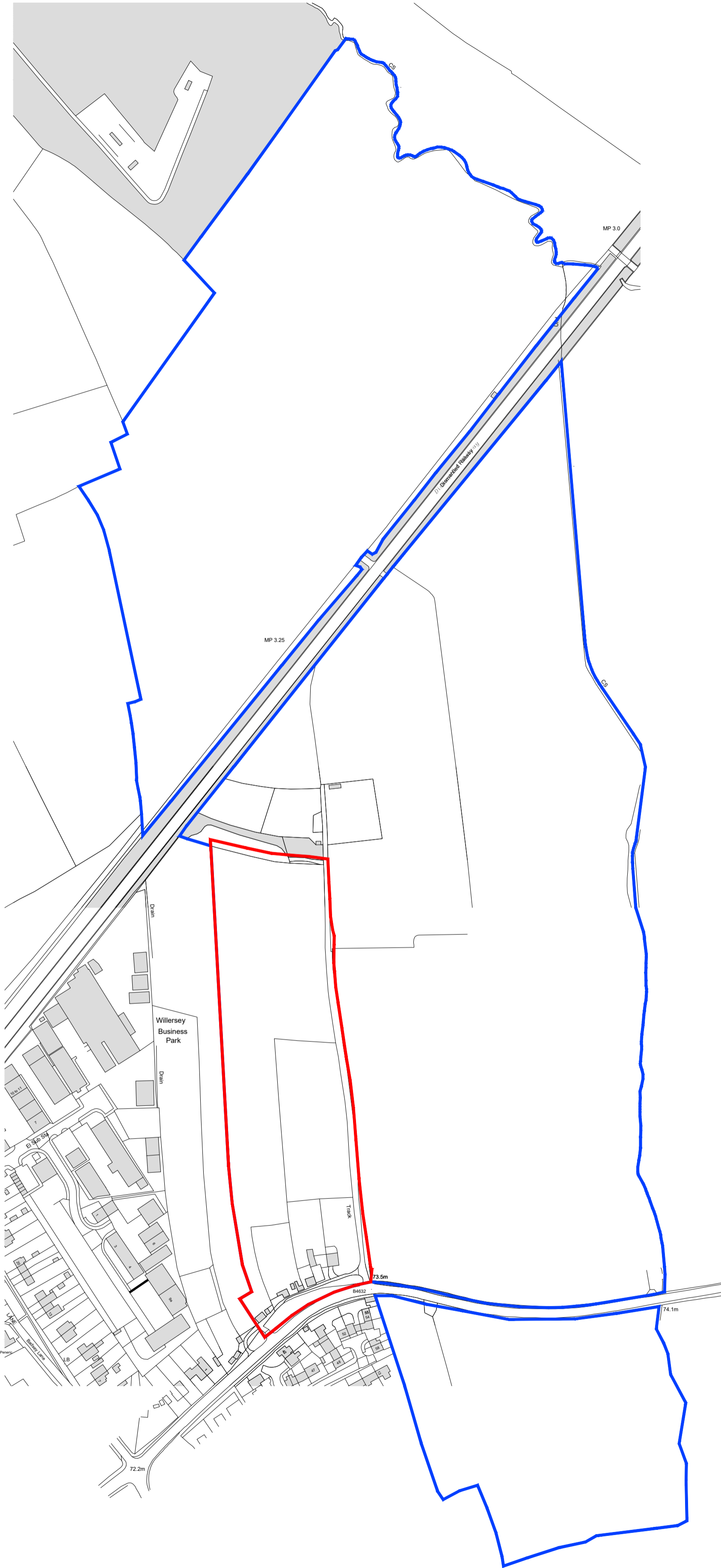

- Application Boundary
- Land within applicants ownership

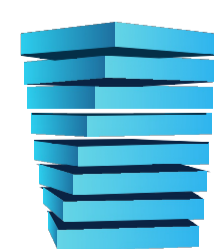
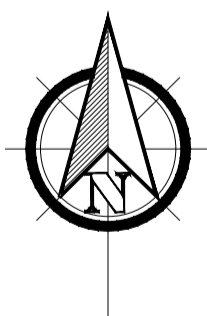

**ERIC COLE ARCHITECTURE**

Eric Cole Ltd. The Old Police Station, First Floor, 21 High Street,  
 Stonehouse, Gloucestershire, GL10 3NG  
 T: +44 (0)1285 641234 E: mail@ericcole.co.uk W: www.ericcole.co.uk

Ordnance Survey, (c) Crown Copyright 2025. All rights reserved. Licence number 100022432

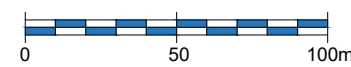

PROJECT:	LAND NORTH OF B4632, WILLERSEY		
DWG TITLE:	SITE LOCATION PLAN		
SCALE:	1:2500 @ A2	DRAWN: RP	CHECKED: RJW
DWG NO:	24.050.1000	REV: 2	DATE: MAY 25