

4 Concept Design

Appendix B

6

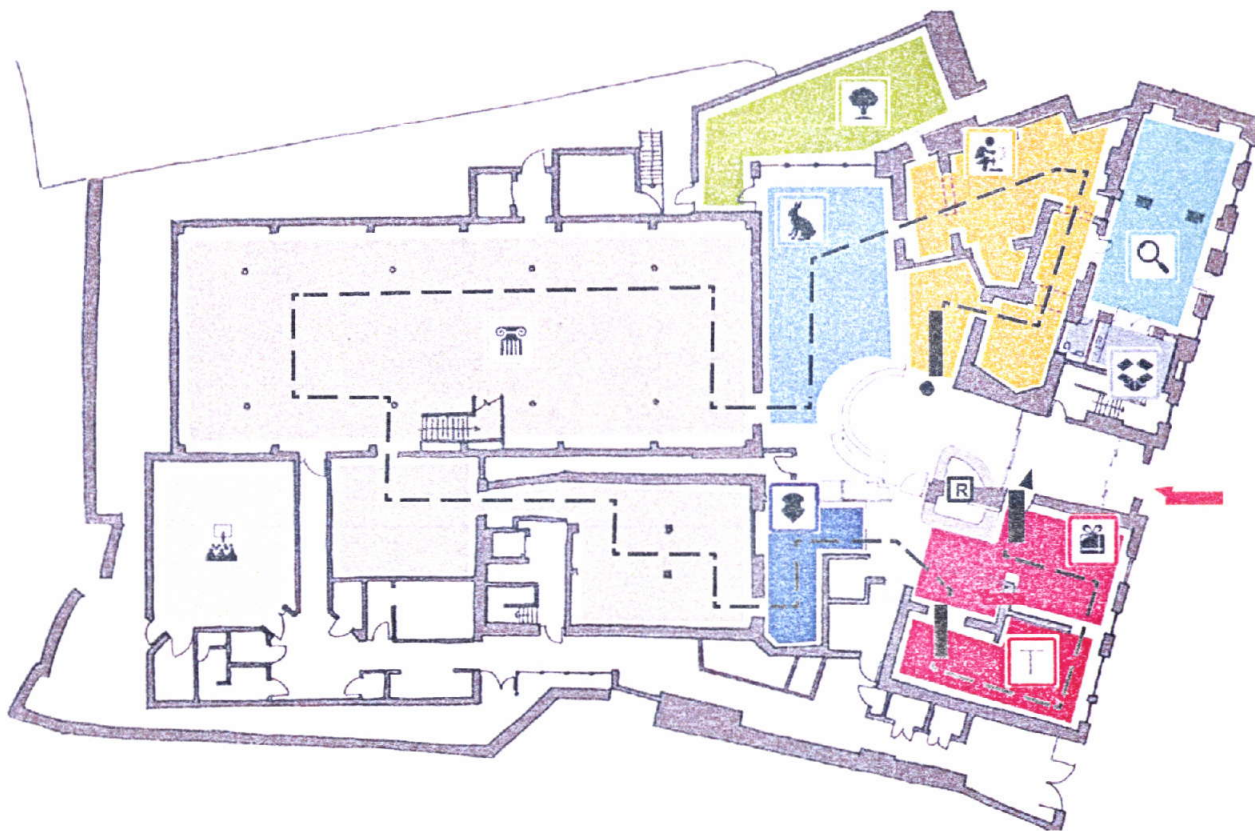

Concept design

This plan illustrates the re-arranged museum spaces and proposed visitor route.

The following pages illustrate our concept ideas on a space by space basis and suggest the character of environment and experience which may emerge during further design development.



10



7 Discovery centre

Formerly the Iron Age and Roman Military galleries. This space is within the Grade 2 listed Abberley house and occupies the principle street facing rooms. As configured these spaces askew the use of natural light, with closed shutters resulting in a static window display to the street. The interior appears to be C20th; however, the remains of historic building fabric may lay behind the more modern linings. The space is partially divided by columns into two sections. This division may be useful in subdividing centre activities in use.

Proposal - The Discovery Centre is one of the primary drivers for this project, it is required to accommodate up to 40 people engaged in variety of activities including museum collections work. Our proposal strips away the modern linings to reveal the building fabric behind. It is anticipated that this may include the remains of mouldings and other historic building features, but is also likely to reveal some of the building work and adaptations which have taken place over the years. Thus revealed, surfaces will be stabilised and left exposed in the finished room, as part of the story of the museum and the history of Cirencester.

This potentially less clean and finished, rougher finish is more engaging than a sterile casing and more stimulating in the context of investigation and discovery. The windows will be unblocked and refurbished to provide an enticing view into the building from outside. The existing blocked door will also be re-opened to provide (subject to programming and other considerations) direct access from the street.

We propose a 'Resources Wall' to be located along the back wall. This free standing piece of furniture would include display shelving, cupboards for storage of education resources for easy access and be designed as a visually engaging feature when viewed from the street. At one end part of the former gallery will be sectioned off to provide a WC for Discovery Centre users, basin for cleaning up and additional resources and furniture storage space.

Discussion - It is unclear whether water and waste services currently serve this part of the building. Installation of new drains will involve excavation and connection to the foul sewer. This requirement may influence the final location of basin and WC facilities.

