

- NOTES:**
- TOTAL NUMBER OF SPACES IN EXISTING LAYOUT = 245 (INCLUDING 4 DISABLED SPACES)
 - TOTAL NUMBER OF SPACES IN PROPOSED LAYOUT = 192 (INCLUDING 12 DISABLED SPACES)
 - N.B. NUMBERS QUOTED ABOVE FOR PROPOSED LAYOUT ASSUME LIGHTING COLUMNS WILL BE RE-LOCATED SO AS NOT TO BLOCK ANY SPACES.
 - EXISTING LAND OWNERSHIP BOUNDARY IDENTIFIED FROM GDC LAND OWNERSHIP PLAN DATED 30/06/2013. HIGHWAY BOUNDARY SUBJECT TO CONFIRMATION BY GDC HIGHWAYS.

- LEGEND:**
- PROPOSED PARKING BAY (2.5m x 4.8m)
 - PROPOSED DISABLED PARKING BAY (IN ACCORDANCE WITH THE BUILDING REGS. PART M, SECTION 1 (DIAGRAM 2))
 - PEDESTRIAN ROUTE THROUGH CAR PARK
 - EXISTING LIGHTING COLUMN
 - RE-LOCATED LIGHTING COLUMN
 - PROPOSED PAY & DISPLAY MACHINE / SIGNAGE
 - EXISTING LAND OWNERSHIP BOUNDARY (SEE NOTE 3 ABOVE)
 - EXISTING CAR PARK BOUNDARY WALL
 - PROPOSED ADDITIONAL PUBLIC HIGHWAY

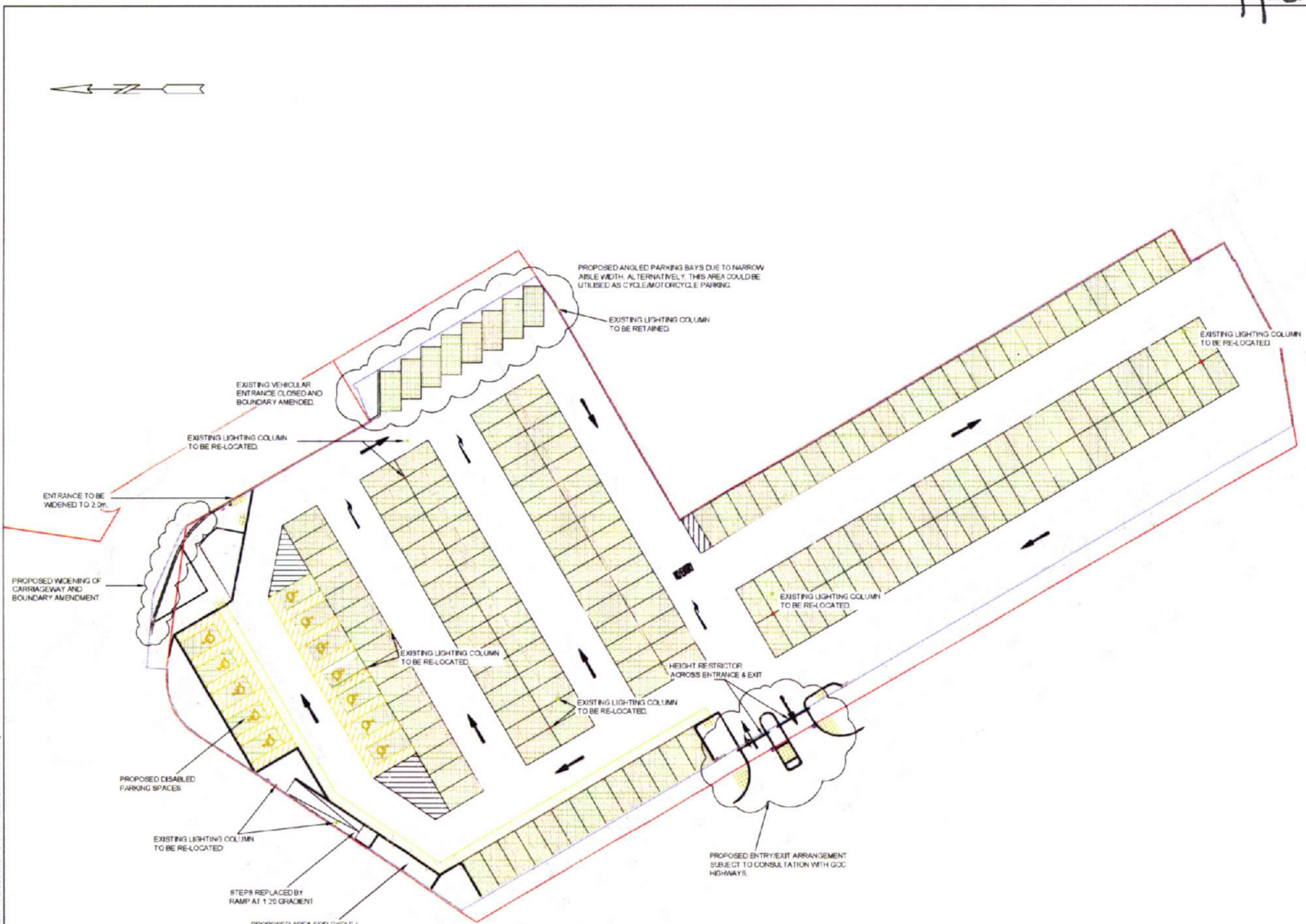

38

LOGO NAME: A4/E: TM
 LOCATION: Cotswold District Council
 DRAWING NUMBER: UN80130-ECC-DG-002
 DATE: 19/11/2013
 DRAWING TITLE: THE FORUM, CIRENCESTER
 PROJECT: OFF-STREET CAR PARK DESIGN & IMPROVEMENT FRAMEWORK
 DRAWN BY: J.A.
 CHECKED BY: T.F.
 DESIGNED BY: G.C.
 DATE: 19/11/2013

REV	DATE	CHANG	REVISED	APPROVED	REVISION
D	20.07.2014	TF	GC		HEIGHT RESTRICTOR THROUGH A1 NEIGHBOURHOOD
E	11.02.2014	TF	TF		LAND OWNERSHIP BOUNDARY AMENDED & EXISTING BOUNDARY WALLS RE-LOCATED
B	04.02.2014	TF	TF	GC	NO. OF DISABLED BAYS INCREASED & PED. ROUTE THROUGH CAR PARK REVISED. NORTH BAY STREET TO SOUTH BAY REMOVED. ACCESS POINTS AMENDED.
A	19.11.2013	JL	TF	GC	PRELIMINARY ISSUE FOR COMMENT.

PRELIMINARY ISSUE



CUSTOMER: COTSWOLD DISTRICT COUNCIL

PROJECT: OFF-STREET CAR PARK DESIGN & IMPROVEMENT FRAMEWORK

DRAWN	DRAWING CHECK	REVISION	APPROVED
J.A.	TF	TF	GC
DESIGNED	DESIGN REVIEW	DATE	DATE
TF	GC	19.11.2013	19.11.2013

TITLE: THE FORUM, CIRENCESTER
PROPOSED CAR PARK LAYOUT

SCALE: 1:200
DRAWING NO: UN80130-ECC-DG-002
REV: D